

**DC 1500 V**

**SQB-DC 0**

 **usE180276**

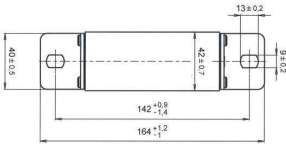
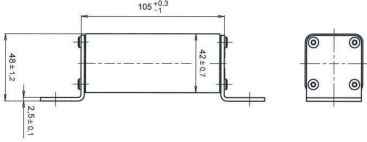

90 223 38

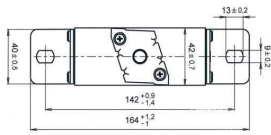
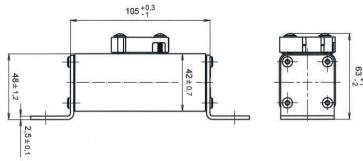

90 223 39

Verpackungseinheit / Packing unit: 1 Stück / 1 pieces

Betriebsklasse / Class  
aBat (IEC)/aR (UL)

IEC 60269-1  
IEC 60269-7  
UL 248-13

Bemessungs- spannung Rated Voltage	Artikel Nr. Article No	Größe Size	Bemessungsstrom Rated Current
V			
DC1500	90 223 38 90 223 39	SQB-DC 0	25-200

Bemessungsausschaltvermögen / Rated breaking capacity

260 kA @ DC 1500 V L/R = 3 ms

Bemessungsstrom Rated Current	Artikel Nr. Article No.	Gewicht Weight	Schmelzintegral Pre-Arcing- I <sup>2</sup> t-Value	Ausschaltintegral Total I <sup>2</sup> t-Value	Leistungsabgabe Power Loss
A		kg / 1	A <sup>2</sup> s	A <sup>2</sup> s	W
25	90 223 38.25 90 223 39.25	0.60	20	200	15
32	90 223 38.32 90 223 39.32	0.60	46	470	17
40	90 223 38.40 90 223 39.40	0.60	81	830	23
50	90 223 38.50 90 223 39.50	0.60	128	1.300	28
63	90 223 38.63 90 223 39.63	0.60	184	1.900	34
80	90 223 38.80 90 223 39.80	0.60	414	4.200	41
100	90 223 38.100 90 223 39.100	0.60	1.000	10.200	50
125	90 223 38.125 90 223 39.125	0.60	1.650	16.800	60
160	90 223 38.160 90 223 39.160	0.60	2.500	25.500	74
180	90 223 38.180 90 223 39.180	0.60	4.000	40.600	75
190	90 223 38.190 90 223 39.190	0.60	5.250	53.500	69
200	90 223 38.200 90 223 39.200	0.60	6.600	67.000	72

Applikationskoeffizienten / Application coefficients (Weiterführende Informationen [hier zum Download](#) / for more information [download here](#))

a	A2	B1 max.	B2	Cf3
130	0,6	1,25	0,6	0,8

DC 1500 V

SQB-DC 0

 usE180276

Zeit/Strom-  
 Kennlinien  
 Time-current  
 characteristics

